

BY	
REVISIONS	
5/15/05	KS
9/15/05	KS
10/21/05	KS

A Custom Home:

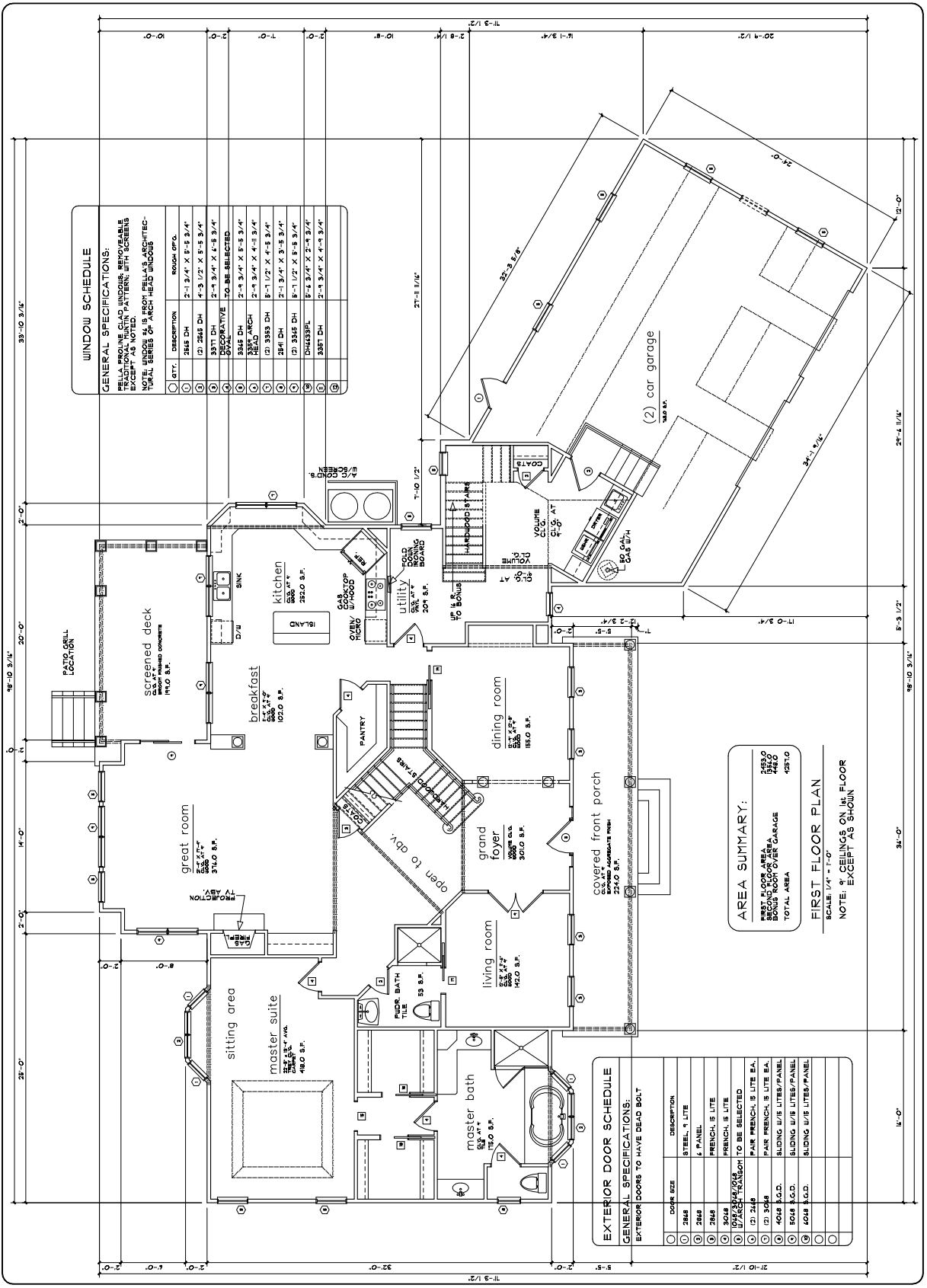

DRAWN	
CHECKED	
NOI	
DATE	7/29/05
SCALE	1/4" = 1'-0"
JOB NO.	2005033
SHEET	7



**WINDOW SCHEDULE**

GENERAL SPECIFICATIONS:  
 ALL WINDOWS TO BE 1/2" INSULATED GLASS UNITS WITH LOW-E GLASS.  
 EXCEPT AS NOTED, ALL WINDOWS TO BE OPERABLE.  
 TOTAL PERCENTAGE OF GLAZING TO BE 15% OF TOTAL FLOOR AREA.

QTY.	DESCRIPTION	ROUGH O.P.C.
1	2616 DH	2'-0" X 3'-4" X 4'-8" 3/4"
1	(2) 2616 DH	4'-3" 1/2" X 5'-5" 3/4"
1	3371 DH	2'-0" X 3'-4" X 4'-8" 3/4"
1	3371 DH	2'-0" X 3'-4" X 4'-8" 3/4"
1	3385 ARCH	2'-0" X 3'-4" X 4'-8" 3/4"
1	3385 ARCH	2'-0" X 3'-4" X 4'-8" 3/4"
1	3541 DH	2'-0" X 3'-4" X 4'-8" 3/4"
1	(2) 3541 DH	2'-0" X 3'-4" X 4'-8" 3/4"
1	(2) 3545 DH	2'-0" X 3'-4" X 4'-8" 3/4"
1	3587 DH	2'-0" X 3'-4" X 4'-8" 3/4"
1	3587 DH	2'-0" X 3'-4" X 4'-8" 3/4"

**EXTERIOR DOOR SCHEDULE**

GENERAL SPECIFICATIONS:  
 EXTERIOR DOORS TO HAVE DEAD BOLT

DOOR SIZE	DESCRIPTION
2648	STEEL, 1 LITE
2648	L PANEL
2648	FRENCH, 5 LITE
3048	FRENCH, 5 LITE
1048	PAIR FRENCH, 5 LITE EA.
121	PAIR FRENCH, 5 LITE EA.
4018	SLIDING 1/2" LITE/PANEL
5018	SLIDING 1/2" LITE/PANEL
4018	SLIDING 1/2" LITE/PANEL

**AREA SUMMARY:**

FIRST FLOOR AREA	2453.0
SCREENED DECK	192.0
SCREENED PORCH	192.0
TOTAL AREA	4377.0

**FIRST FLOOR PLAN**  
 SCALE: 1/4" = 1'-0"  
 NOTE: 9' CEILINGS ON 1st FLOOR  
 EXCEPT AS SHOWN

